

महाराष्ट्र MAHARASHTRA  
22 NOV 2016

© 2015 ©

PW 309671

दिनांक - १५/११/१६ विक्र. १५५८५ मुद्रांक शुल्क रक्कम - १००  
दस्त नोंद करणार आहे का-होय/नाही, नोंदणी होणारे दु.नि.कार्या.-----  
दस्ताचा प्रकार / अनुच्छेद क्रमांक / कारण -----  
मुद्रांक विकत घेणाऱ्याचे नांव व पत्ता -----  
दुराऱ्या पक्षकाराचे नांव व पत्ता -----  
हरते नांव व पत्ता -----  
मोबदला रक्कम - १५५८५ मिलकतीचे वर्णन -----  
मुद्रांक विक्रीसाठी नाही/-  
पदावना तसेच मुद्रांक विक्रीचे ठिकाण नांव व पत्ता - चंद्रकांत सिताराम पिंपळे  
(स्टॅप वॉर्डर) ला. नं. ११९/८८,  
कोड नं. २६०१०३२ महालक्ष्मी चॅम्बर्स, शाँप नं. ई-२८, कोल्हापूर.  
मुद्रांक विकत घेणाऱ्याची सही/-



16 NOV 2016

STAMP HEAD CLERK  
TREASURY OFFICE  
KOLHAPUR (M.S.)

AFFIDAVIT





I Mrs. GAVADE SHUBHANGI MURLIDHAR Wife of Shri Mr.GAVADE MURLIDHAR, the SECRETARY address 458  
B,SOMWARPETH, PANTHACH KOT,KARAD.TAL- KARAD DIST- SATARA, 415110, KARAD, Satara, Maharashtra,phone No. 02164-222495  
mobile No. 9421216285 Email ID knjckarad@yahoo.in am authorised to make this affidavit on the Tuesday Tuesday, November 22, 2016. Affirm  
that I am well conversant with all the facts and details, pertaining to KAMALA NEHARU JR.COLLEGE OF EDUCATION,KARAD and confirm  
the following averments: -

- (i) That the KAMALA NEHARU JR.COLLEGE OF EDUCATION,KARAD institution is running under the SHRI SWAMI VIVEKANAD  
SHIKSHAN SANSATHA,KOLHAPUR



(ii) The latest list of members of the society/trust duly endorsed by the concerned Registrar of the Society with their designation and address. A copy of the proof is enclosed at Annexure -1.

(iii) The KAMALA NEHARU JR.COLLEGE OF EDUCATION,KARAD institution is having a Managing Committee as per provisions of the NCTE Regulations, 2014 and the Managing Committee is consisting of the following :-

Members Name	Mobile No	Designation	Fa/Hu Name	Email ID	Photo
Hon. Patil Chandrakant Bacchu	9422304150	President	Bacchu		
Prin. Sakankhe Abhaykumar Govindrao	9822406868	Executive President	Govindrao		
Prin. Gavade Shubhangi Murlidhar	9822842727	Secretary	Murlidhar		

(iv) That as per the certificate submitted by the society/trust, it has been established and managed as a 'not for profit' entity registered under the appropriate laws. Yes. A copy of the proof is enclosed at Annexure -2

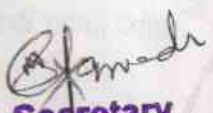
  
**Secretary**  
**Shri Swami Vivekanand Shikshan Sanstha**  
**Kolhapur.**



X

under the appropriate laws. Yes. A copy of the proof is enclosed at Annexure -2

- (v) Also in case the institution is a minority institution, the same is required to submit a certificate from the concerned State Govt./Central Govt./ authority competent to issue the Minority Status Certificate with the following details (Applicable to Self Financed Pvt. Institutions running under the Society/Trust) :-Not Applicable

A copy of the proof is enclosed at Annexure -3

- (vi) That the society/trust is having PAN/TAN Card No. PNEK06313G.



**National Securities Depository Limited**  
 e-TDS Intermediary

TO: KAMALA NEHARU JR COLLEGE OF EDUCATION KARAD  
 KARAD  
 DISTRICT: SOLAPUR  
 TEL. NO. 0209421118

Sub: Allotment of Tax Deduction Account Number (TAN)  
 as per the Income Tax Act, 1961

Kindly refer to your application (Form 49B) dated: Feb 14, 2005 for allotment of Tax Deduction Account Number. In this connection, the following TAN has been issued to you/your organization:

**PNEK06313G**

Please quote the name in all TDS challans, TDS certificates, TDS returns, Tax Collection at Source (TCS) returns, as well as other documents pertaining to such transaction.

Quoting of TAN on all TDS returns and challans for payment of TDS is necessary to ensure credit of TDS paid by you and faster processing of TDS returns.

The above TAN should also be cited as Tax collector at Source Account Number under Section 106CA.

Kindly note that it is mandatory to quote TAN while furnishing TDS returns, including e-TDS returns. e-TDS return will not be accepted if TAN is not quoted.

This supersedes all the TAXDeductions/Collection Account Number, allotted to you earlier.

Income Tax Department

This is a computer-generated letter. Hence, signature is not required.

- (vii) That KAMALA NEHARU JR.COLLEGE OF EDUCATION,KARAD institution has filled in the information related to Geographical Information System (GIS) mapping data and information is as under:-

Latitudinal Position of Institute *(eg: 28.63530800)	17.293512
Longitudinal Position of Institute *(eg. 77.22496000)	74.176199



The GIS generated No. is 3038930 A copy of the proof is enclosed at Annexure -4



- (viii) That KAMALA NEHARU JR.COLLEGE OF EDUCATION,KARAD the accreditation from the National Assessment and Accreditation Council (NAAC) not applied. (A copy of the proof is enclosed at Annexure -5 )
- (ix) That KAMALA NEHARU JR.COLLEGE OF EDUCATION,KARAD the institution has obtained accreditation from the Quality Council of India (QCI) under registration No. is TEIEM003346 (A copy of the proof is enclosed at Annexure -6 )
- (x) That KAMALA NEHARU JR.COLLEGE OF EDUCATION,KARAD institution has paid prescribed fee to the QCI in connection with E- monitoring of its website.  
Paid (A copy of the proof is enclosed at Annexure -7 )
- (xi) That KAMALA NEHARU JR.COLLEGE OF EDUCATION,KARAD institution is having its own website as www.kamlanehrudedkarad.com The institution undertakes that the same has been developed as per clause 7(14) of the NCTE Regulation, 2014.
- (xii) That the institution undertakes that it fulfils the requirement of land & building as per provision of the NCTE Regulation issued from time to time and the details of which are given below:-

<b>Institutions is running the following Teacher Education programs (Name of the Programs)</b>	Diploma in Elementary Education(D.El.Ed.),
<b>Level of the Programs</b>	Elementary
<b>Year during which recognition granted</b>	1955
<b>Intake</b>	40
<b>Institution Type</b>	This is a Stand alone Institution

(A copy of the proof is enclosed at Annexure -8 )

- a). That the Institution is having required land in the name / favour of SHRI SWAMI VIVEKANAD SHIKSHAN SANSATHA,KOLHAPUR or KAMALA NEHARU JR.COLLEGE OF EDUCATION,KARAD (Society/ Trust/ Institute) vide ..... (Sale deed/ Gift Deed/ Lease Deed from Govt. or Private for a period of not less than 30 years duration) dated ..... executed by ..... and duly registered in the office of Registrar/Sub-Registrar ..... and actual location of the land is ..... (See Instruction no. iv(d) for details).  
(A copy of the proof is enclosed at Annexure -9 )
- b). That the Institution has got the mutation of the land done by the competent land and revenue authority vide order No.1382 Date YYYY/MM/DD (A copy of the proof is enclosed at Annexure -10 )
- c). That the Management of the institution has displayed a copy of the affidavit submitted at the time of making application for grant of recognition on its official website www.kamlanehrudedkarad.com (A copy of the proof is enclosed at Annexure -11 )
- d). In case of lease, No. of years of lease self
- e). Land area in sq. meters 1868.00
- f). Built up area in sq. meters 1423.75
- g). That the institution undertake that the land and permanent building are at the same place as per provisions of the NCTE Act, Rules & Regulations. The building plan has been approved by KARAD NAGARPARISHAD (Competent authority) and Countersigned by SHAIKH SALIM G for Plot No. 458B, 429K /Khata/khasra No. 1003113 reflecting total land area 1868 Total Built up area is 1423.75 (A copy of the proof is enclosed at Annexure -12 )
- h). The building completion certificate issued by KARAD NAGARPARISHAD (Competent Authority) Counter signed by SHIKH SALIM G for Plot No. 458B, 429K/khata No./ khasra No. 1003113 .reflecting total land area 1868 Total Built up area 1423.75 The building is complete in all respect. A copy of the approved Building Completion Certificate (BCC).(A copy of the proof is enclosed at Annexure -13 )
- i). The Institution undertakes that it fulfils the requirement of dimensions of classrooms, laboratories, library, multipurpose hall, floor wise area, total area etc as per provisions of the NCTE Regulation. The following Photographs are given below.



Front view of the Building



NOTARY  
JAYAMANT K. DESAI  
ADVOCATE & NOTARY  
KOLHAPUR  
Regd. No. 4131  
GOVT. OF INDIA

Rear view of the building



Multipurpose Hall





Library-cum-Reading room

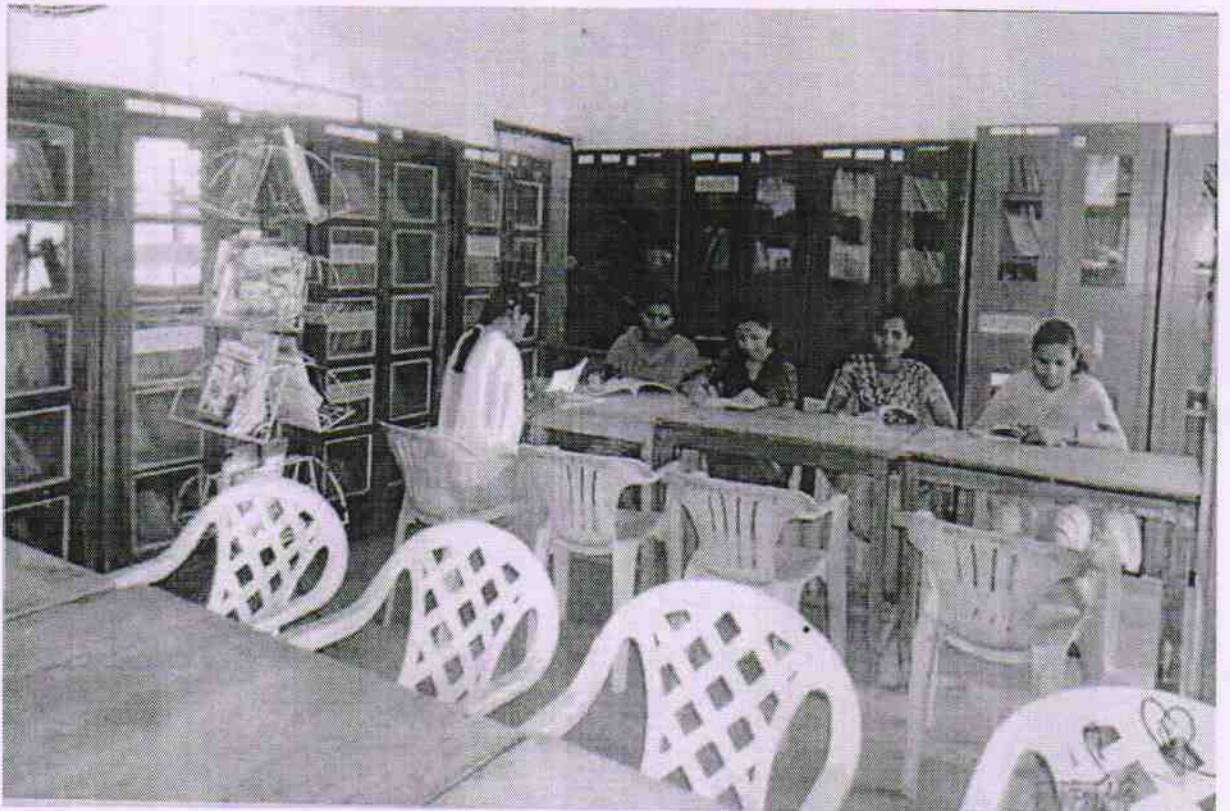







(xiii) The Institution also undertakes that it has obtained the required permission from the competent authority for running various other programmes (if running) in addition to the teacher training programme and the institution is having requisite land & built up area earmarked for running the existing teacher education programme as per the provisions of the NCTE Act, Rules & Regulations in force at the time of granting recognition for particular courses.

GPF

(xiv) The institution undertakes that it fulfills the requirement of faculty (teaching & non teaching) as per provisions of the NCTE Regulations issued from time to time as also the conditions laid down by the State Govt./affiliating body wherever necessary and the details are given below .

S.No.	Faculty Name	Type	Designation	Fa/Hu Name	Experience	Photo
1	SOU CHAVAN ARUNA DILIPRAO	Full Time	PRINCIPAL	DILIPRAO	24	
2	SOU POTDAR ANITA ANAND	Full Time	ASST.TEACHER	ANANAD	15	
3	SHRI GALTAGE MILIND MAHADEV	Full Time	ASSIT.TEACHER	MAHADEV	13	
4	SOU SHENDURE VISHAKHA ANIL	Full Time	ASSIT.TEACHER	ANIL	13	
5	SHRI GHUGE EKNATH JANARDHAN	Full Time	ASST.TEACHER	JANARDHAN	6	
6	SHRI KASBE ANAND BABURAO	Full Time	ASST.TEACHER	BABURAO	3	
7	SHRI KHATAKI RAJARAM BANDOPANT	Full Time	ASST.TEACHER	BANDOPANT	3	

						
8	SHRI MOHITE ASHOK ANNA	Full Time	JR.CLERK	ANNA	21	
9	SHRI MANE NAMADEV RANGRAO	Full Time	PEON	RANGRAO	21	
10	SHRI KOLEKAR RAHUL SHIVAJI	Full Time	PEON	SHIVAJI		



Faculty Education details are given below (A copy of the proof is enclosed at Annexure -14.)

Faculty Name	SOU CHAVAN ARUNA DILIPRAO	Professional Courses	M ED
Subjects	SCIENCE	Aadhar Card No.	411013505359
Obtains Marks	64%	Passing Year	1997
Faculty Name	SOU POTDAR ANITA ANAND	Professional Courses	M ED
Subjects	SCIENCE	Aadhar Card No.	206049927088
Obtains Marks	73%	Passing Year	2005
Faculty Name	SHRI GALTAGE MILIND MAHADEV	Professional Courses	M ED
Subjects	EDUCATION	Aadhar Card No.	871723679568
Obtains Marks	61%	Passing Year	2001
Faculty Name	SOU SHENDURE VISHAKHA ANIL	Professional Courses	M ED
Subjects	EDUCATION	Aadhar Card No.	810864856809
Obtains Marks	68%	Passing Year	2011
Faculty Name	SHRI GHUGE EKNATH JANARDHAN	Professional Courses	M ED
Subjects	EDUCATION TECNOLOGY	Aadhar Card No.	857327768905
Obtains Marks	71%	Passing Year	2008
Faculty Name	SHRI KASBE ANAND BABURAO	Professional Courses	M ED
Subjects	EDUCATION	Aadhar Card No.	348057368198
Obtains Marks	70%	Passing Year	2010
Faculty Name	SHRI KHATAKI RAJARAM BANDOPANT	Professional Courses	M ED
Subjects	EDUCATION	Aadhar Card No.	943442834213
Obtains Marks	71%	Passing Year	2007

#### CERTIFICATE FROM THE MANAGEMENT/GOVT. INSTITUTION

- (i) All appointments are on full-time and regular basis except those specified as part-time as per the NCTE norms. The academic staff of the institution (including part-time staff) is/shall be paid salary in such scale of pay as prescribed by the UGC/Central Govt./State Govt. from time to time through account payee cheque or as per advice into the bank account of employee specially opened for the propose. The supporting staff shall be paid as per the UGC/State



Government/Central Government pay scale structure.

- (ii) The management of the institution/Govt. Institution shall discharge the statutory duties relating to pension, gratuity, provident fund, etc an applicable under law. for its employees. The institution shall follow all the norms of the NCTE as amended from time to time.



*[Signature]*  
**Secretary**  
**Shri Swami Vivekanand Shikshan Sanstha**  
**Kolhapur.**

- (xv)- The institution undertakes that it has created FDRs of requisite amount in the form of Reserve Fund and Endowment Fund for each programme separately and got jointly operated and the same are maintained, as per provisions of the NCTE Regulation issued from time to time as also conditions laid down by the State Govt./affiliating body, wherever necessary, and the details of the FDRs towards Endowment Fund & Reserve Fund as per provisions of clause 10 (1 & 3) of the NCTE Regulations 2014, are mentioned as under:-

(a) For Reserve Fund

S.No.	Name of Prog.	FDR No.	Date	Name of the Bank	Amount
1	Diploma in Elementary Education(D.El.Ed.)	0	0	0	0

(b) For Endowment Fund

S.No.	Name of Prog.	FDR No.	Date	Name of the Bank	Amount
1	Diploma in Elementary Education(D.El.Ed.)	0	0	0	0

- (xvi) That the institution undertakes that it maintains complete record of payment of salary to the employees, employees provident fund as per the provisions of the concerned Govt. or board or affiliating body by account payee cheque or as per advice into the bank account of the employee specially opened for the purpose.

Yes

- (xvii) The Institution undertakes that it has been displaying on its official website, every financial year by 30th Day of September, the following statement of accounts duly certified by a Chartered Accountant:-

- (i) Balance sheet as on the last date of the financial year;



**SHRI SWAMI VIVEKANAND SHIKSHAN SANSTHA'S**  
Kamala Nehru Jr. College Of Education, Karad  
Tal:-Karad, Dist:-Satara

**INCOME AND EXPENDITURE ACCOUNT FOR THE YEAR ENDED MARCH 31, 2016**

Expenditure	₹	₹	Income	₹	₹
To Salary expenses		46,35,433.00	By Grants -		
To Building rent - SSVSS		28,345.00	Salary grant	45,58,158.00	46,51,715.00
To Municipal/ local taxes		38,102.00	Term fee grants	16,289.00	
To Educational expenses		78,597.00	Medical grants	75,275.00	
To Super/Vision charges		49,000.00	By Other income -		
To Term fee expenses		7,275.00	Fees from students	1,01,850.00	1,01,850.00
To Depreciation		25,150.00	By Interest income -		
			Bank Interest	48,707.00	48,707.00
			By Deficit		59,623.00
<b>Total</b>		<b>₹ 48,61,903.00</b>	<b>Total</b>		<b>₹ 48,61,903.00</b>

**BALANCE SHEET AS ON MARCH 31, 2016**

Liabilities	₹	₹	Assets	₹	₹
SSVSS		21,49,607.97	<b>Fixed assets</b>		
School Development Fund		6,000.00	[ Refer schedule attached ]		66,791.00
<b>Scholarships-</b>		1,38,918.71	<b>Other -</b>		8,37,378.17
B.C scholarship	20,080.00		Pre-building a/c	4,53,526.17	
Free ship	3,294.00		Building SDF a/c	3,75,865.00	
VINT Scholarship	31,940.71		Nivad Shreni 1	8,187.00	
SBC Scholarship	59,604.00		<b>Scholarship and exam fees -</b>		265.84
CHC & SBC Free ship	40,000.00		Scholarship Remuneration/Pritsangam	227.70	
Scholarship Nivah Allowance	5,670.00		Janata Bank	38.14	
<b>Other accounts -</b>		2,56,896.95	<b>Cash and bank balances -</b>		12,69,251.88
LIC	8,589.00		Cash in hand Main Kind	340.00	
Krudhryata Nidhi	230.00		Cash in hand - Term	49.00	
Nivad Shreni 2	8,270.00		Bank Joint account (Salary)	100.60	
Service Charges	245.30		Bank account (Non-salary)	10,78,217.48	
Remuneration	3,706.00		Bank Current A/c	201.90	
Other Deposite	2,35,872.95		Satara DC Bank	86,875.90	
<b>Individual a/c</b>		1,05,461.40	Bank Of Maharashtra S/s	38,130.00	
Intra-branch a/c		4,25,219.42	Maharashtra Bank (Anudhan)	2,042.00	
Training School			Postal Training Bank	64,145.00	
			Cash (Postal Training Fees)	154.00	
<b>Total</b>		<b>₹ 31,02,104.45</b>	<b>Income and expenditure account</b>		9,33,417.56
			Balance b/d	8,73,794.56	
			(+)/(-) Deficit/ (Surplus)	39,623.00	
			<b>Total</b>		<b>₹ 31,02,104.45</b>

Note :

Balance confirmation the bank current a/c Rs-201.90 were not furnished

Examined and found correct -

For P V PHATAK & ASSOCIATES  
Firm registration number : 136411W  
Chartered Accountants

  
Vrushali Phatak  
Partner  
Membership No: 137548



(ii) Income and expenditure account for the financial year;



Receipts	₹	₹	Payments	₹	₹
S.S.V.S.S.		1,06,753.00	S.S.V.S.S.		17,744.00
<b>SALARY DEDUCTIONS</b>		9,40,802.00	<b>SALARY DEDUCTIONS</b>		9,32,213.00
P.F. - Individual	4,38,000.00		P.F. - Individual	4,38,000.00	
Professional tax	25,700.00		Professional tax	25,700.00	
Postal R.D	76,800.00		Postal R.D	76,800.00	
LIC	91,258.60		LIC	82,689.60	
Income tax	1,79,350.00		Income tax	1,79,350.00	
SSVSS Credit society	67,100.00		SSVSS Credit society	67,100.00	
Dividend	18,574.00		Dividend	18,574.00	
Krunadivata Nidhi	44,020.00		Krunadivata Nidhi	44,020.00	
<b>SCHOLARSHIPS</b>		12,140.00	<b>SCHOLARSHIPS</b>		30,510.00
B.C scholarship	4,570.00		B.C scholarship	22,940.00	
5th - 7th Present Allowance	7,570.00		5th - 7th Present Allowance	7,570.00	
<b>OTHER ACCOUNTS</b>		52,185.00	<b>OTHER ACCOUNTS</b>		72,720.00
Individual	4,000.00		Individual	4,000.00	
Service Charges	85.00		Service Charges	0.00	
Nivad Shree 1	44,400.00		Nivad Shree 1	68,720.00	
Remuneration	3,700.00		Remuneration	0.00	
<b>Term fees (Pr. G Committee)</b>		17,280.00	<b>Term fees (Pr. G Committee)</b>		8,300.00
<b>INDIRECT RECEIPTS</b>	₹	11,29,160.00	<b>INDIRECT PAYMENTS</b>	₹	10,61,487.00
<b>OPENING CASH AND BANK BALANCES</b>		12,50,410.88	<b>CLOSING CASH AND BANK BALANCES</b>		12,65,206.88
Cash in hand	24.00		Cash in hand	340.00	
Bank joint account (Salary)	100.00		Bank joint account (Salary)	100.00	
Bank account (Non-salary)	10,47,139.48		Bank account (Non-salary)	10,73,217.48	
Bank Current A/c	201.90		Bank Current A/c	201.90	
Satara DC Bank	86,875.90		Satara DC Bank	86,875.90	
Bank Of Maharashtra S/B	53,996.00		Bank Of Maharashtra S/B	38,130.00	
Maharashtra Bank (Anudhan)	843.00		Maharashtra Bank (Anudhan)	2,042.00	
Postal Training Bank	61,026.00		Postal Training Bank	64,145.00	
Cash (Postal Training Fees)	154.00		Cash (Postal Training Fees)	154.00	
<b>GRAND TOTAL</b>	₹	72,05,180.88	<b>GRAND TOTAL</b>	₹	72,05,180.88

## TERM FEE ACCOUNT FOR THE YEAR ENDED MARCH 31, 2016

Receipts	₹	₹	Payments	₹	₹
<b>TERM FEE GRANTS</b>		16,280.00	<b>TERM FEE EXPENSES</b>		7,276.00
E.B.C Term Fee	16,280.00		Examinations	1,856.00	
			Functions	1,879.00	
			Newspapers and periodicals	2,840.00	
			Sports equipments	210.00	
			Water supply	491.00	
<b>SCHOOL ACCOUNT</b>		8,300.00	<b>SCHOOL ACCOUNT</b>		17,280.00
OPENING CASH BALANCE		21.00	CLOSING CASH BALANCE		45.00
<b>TOTAL</b>	₹	24,601.00	<b>TOTAL</b>	₹	24,601.00

Examined and found correct

For P V PHATAK & ASSOCIATES  
Firm registration number : 136411W  
Chartered Accountants

*V. Phatak*  
Vrushali Phatak  
Partner  
Membership No: 137548



(iii) Receipt and payment account for the financial year;



**P V PHATAK & ASSOCIATES**  
Chartered Accountants

Office: 302, 3rd Floor, Atharva 4th Dimension  
4th Lane, Rajarampuri, Kolhapur 416008  
Tel/Fax: 0231 2521441  
www.pvassociates.com

**SHRI SWAMI VIVEKANAND SHIKSHAN SANSTHA'S**  
Kamala Nehru Jr. College Of Education, Karad  
Tal: Karad, Dist: Satara



**RECEIPT AND PAYMENT ACCOUNT FOR THE YEAR ENDED MARCH 31, 2016**

Receipts	₹	₹	Payments	₹	₹
<b>SALARY GRANT</b>		46,55,238.00	<b>SALARY EXPENSES</b>		46,55,238.00
Salary Grant received (Z.P.)	45,78,663.00		Teaching and non-teaching staff -		
Medical grant	76,575.00		Pay	20,93,620.00	
			D.A.	22,32,881.00	
			H.R.A.	1,90,182.00	
			Vehicle allowance	62,000.00	
				45,78,663.00	
			Medical expenses	76,575.00	
<b>SALARY RECOVERY ETC.</b>		19,805.00	<b>SALARY RECOVERY ETC.</b>		19,805.00
Pay	19,805.00		Pay	19,805.00	
			<b>BUILDING RENT</b>		28,545.00
			Sanstha	28,545.00	
			<b>DEADSTOCK, EQUIPMENTS ETC.</b>		9,915.00
			Library	1,810.00	
			Physical education equipments	1,450.00	
			Other deadstock	6,140.00	
			Zerex	515.00	
<b>FEES FROM STUDENTS</b>		1,01,860.00	<b>EDUCATIONAL EXPENSES</b>		1,15,184.00
Admission fees	4,180.00		Stationery	8,033.00	
Tuition fees - current	97,680.00		Travelling	5,317.00	
			Deadstock repairs	7,635.00	
			Work experience expenses	100.00	
			Audit fees	1,150.00	
			Miscellaneous expenses	7,487.00	
			Telephone	15,472.00	
			Municipal/ local taxes	38,102.00	
			Registration fees	3,000.00	
			Computer repairs and maintenance	2,240.00	
			Postage	926.00	
			Electricity charges	15,900.00	
			Peon washing and uniform allowance	2,760.00	
<b>OTHER RECEIPTS</b>		48,707.00	<b>SUPERVISION CHARGES (H.O.)</b>		49,000.00
Bank interest (Non-salary bank)	48,707.00				
<b>DIRECT RECEIPTS</b>	₹	48,25,610.00	<b>DIRECT PAYMENTS</b>	₹	48,78,487.00

Continued.....

(xviii) The institution undertakes that it is adhering to the Academic calendar of activities prescribed by the affiliating University/Board or any other agency decided by the State Govt.

Yes

(xix) Whether the institution maintain a placement cell for its student. Yes

**Statement indicating details of passed out students who have cleared TET and got employment in Govt. or Private Institutions**

(a) Details of the students passed out, cleared TET and got employment in Govt. or Private Institutions (For the last three years)

S.No.	Name Of Student Passed Out With Year Of Passing	No. Of Student clear TET	No. Of S Got Emp Private	No. Of S Got Emp Government
-------	---	--------------------------	--------------------------	-----------------------------

1	Year 2016, Students Passed 16	0	10
---	-------------------------------	---	----



(xx) Whether the institution has an Alumni Association. Yes.

Name & Designation of the person Incharge for the placement cell who is also maintaining the record of passed student teachers , course wise TET qualified and got employment. Shri Ghuge Ekanath Jagannardhan

Name & Designation of the employee acting as Incharge of Alumni Association Lohar shobha navaji

(xxi) The institution undertakes that it has made adequate provisions for conducting 20 weeks Internship (School Experience Programme/Teaching Practice) (spread over 4 weeks & 16 weeks in 1st year & 2nd year). The details of the arrangement so made are given below

S.No.	Name Of the course	Name of the school	Letter & Date of permission given by DEO/Head of school
1	D EL ED	PRACTISING SCHOOL KARAD	2009/10/186
2	D EL ED	Karad.M.C.School No.03	2009/10/187
3	D EL ED	Karad.M.C.School No.07	2009/10/188
4	D EL ED	Karad.M.C.School No.12	2009/10/189
5	D EL ED	Karad.M.C.School No.09	2009/10/190
6	D EL ED	Karad.M.C.School No.10	2009/10/191
7	D EL ED	Z.P.School Gote	2015/16/192
8	D EL ED	Z.P.School Munde	2009/10/192
9	D EL ED	Z.P.School Karve	2009/10/193
10	D EL ED	Z.P.School Korti	2009/10/194

(xxii) Additional points

i. Whether the recognition granted to any of the programs was withdrawn No

ii. Period of withdrawal of recognition Not applicable

iii. Date of restoration

## UNDERTAKING

1. That the Management of the institution/Govt. Institution undertakes to comply with the provisions of the clause 8(13) of the NCTE Regulation, 2014 which provides that the institution shall maintain records or registers and other documents etc. which are essential for running of an educational institution especially those prescribed in the relevant norms and standards and guidelines or instructions of the Central or State or Union Territory Governments, affiliating or examining bodies.
2. That the Management of the institution/Govt. Institution undertakes to comply with the provisions of clause 8(14) of the NCTE Regulation, 2014 which provides that the institution shall adhere to the mandatory disclosure in the prescribed format and display up-to-date information on its official website.
3. The Management of the institution/Govt. Institution also swears that the status of the recognition of the NCTE for the existing approved teacher education programme stands recognized as on date and there is no legal/withdrawal/appeal case pending against the institution.





DEPONENT



*[Signature]*  
Secretary

**Shri Swami Vivekanand Shikshan Sanstha  
Kolhapur.**

I SOU.CHAVAN ARUNA DILIPRAO above named deponent do hereby verify that the information provided under para No. 1 to 22 including sub-paras wherever given are true and correct to the best of my knowledge and belief. Nothing is false or incorrect and nothing is concealed.

I do understand that in the event of any information provided as above if found incorrect the recognition of teacher education programme being run in my Institution/College/Department will be withdrawn and I will be prosecuted under relevant provision of IPC etc. against such misreporting/providing wrong information

Date & Place

*[Signature]*  
Secretary

**Shri Swami Vivekanand Shikshan Sanstha  
Kolhapur.**

Name & seal of the authorized representative of the management of the institution/Govt. Institution.

*[Signature]*  
**Secretary**  
Signature with Seal  
**Shri Swami Vivekanand Shikshan Sanstha  
Kolhapur.**

Name of the authorized representative of the society/trust/Govt. Institution running the teacher training programme.	<i>[Signature]</i> Mrs. Sou. Shubhangi M. Gawade.
Designation	Secretary
Name of the society/trust/Govt. Institution	Shri Swami Vivekanand Shikshan Sanstha Kolhapur.
Office Address	2/30 E Tarabai Park, Kolhapur. 415003

The above statements are duly sworn before the Notary Public/ADM/SDM/First Class Magistrate

Solemnly affirmed before me  
by Mrs. Sou. Shubhangi M. Gawade  
Who is identified before me  
by Mr. Hitesh Raviya  
Whom I personally know  
This 22 Day of Nov 2016

*[Signature]*  
*[Signature]*  
C.A. G. Rautogad

Signature with Seal of the  
Notary Public/ADM/SDM/First Class Magistrate

**Jaywant Kakasab Desai**  
Advocate & Notary  
Chavan Colony, Post Kalamba, Kolhapur  
22/11/2016

Name of the Notary Public/ADM/SDM/First Class Magistrate	
Office Address	

Annexure 1 : List of members of the society/trust

Notary Regi. Sr. No. 440  
2016.







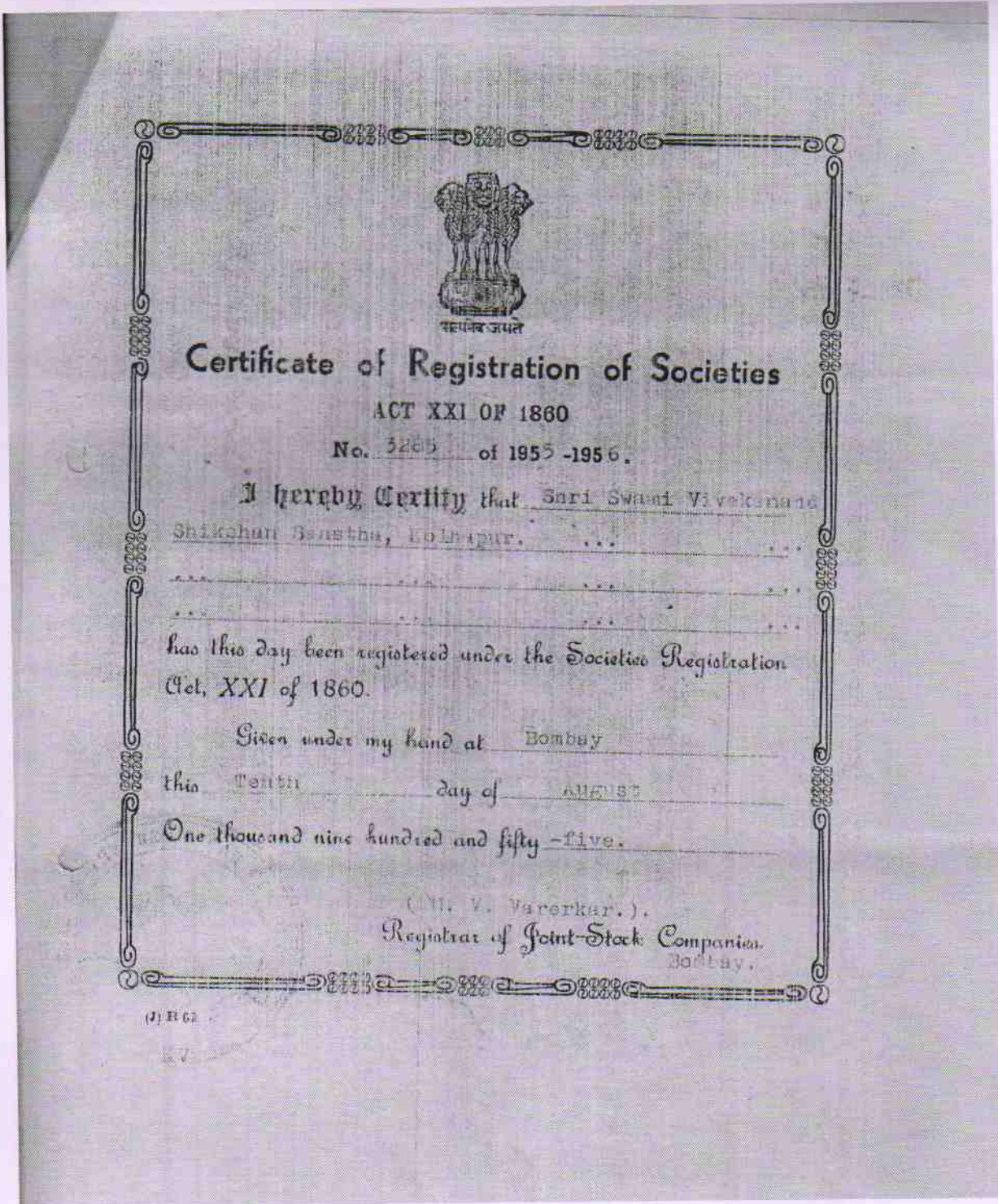

**Annexure 3 : Minority Status Certificate**

**Annexure 4 : Geographical Information System (GIS)**

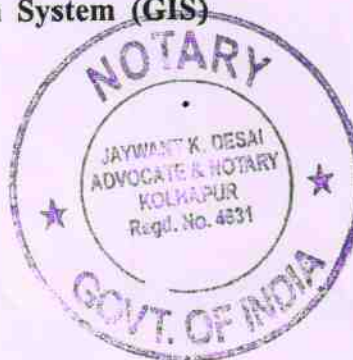



**INSTITUTIONAL GEOGRAPHIC INFORMATION  
SYSTEM (GIS) DATA CAPTURE FORMAT (DCF)**

GIS Application Reference Number	3038930
Name of Institution	KAMLA NEHRU JR. COLLAGE OF EDUCATION, KARAD
Name of Society/Trust/Company	SHRI. SWAMI VIVEKANAND SHIKSHAN SANTHA, KOLHAPUR
Management Category	Government-aided
Institution Category	Only for Women
Whether the Institute is a Composite Institution	No
Whether the Institute is a Minority Institute	No
Address (with Plot No./Khasra No.)	458 B, PANTACHA KOT, SOMWAR PETH,
Name of Village	KARAD
Tehsil/Division	KARAD
State/Union Territory	Maharashtra
District	Satara
Pincode	415110
Mobile Number	9970808600
Landline Telephone Number	02164222495
Latitudinal Position of Institute	17.293512
Longitudinal Position of Institute	74.176199
Jurisdiction Region	West Regional Committee
E-Mail ID	knjckarad@yahoo.in
Website Address	http://kamlanehrudedkarad.com

**Details on Courses Recognised Till Date**

Application ID	Name of Course	No. of Units	Date of Recognition	Recognition Order No	Name of Affiliating University
No.WRC/S-6/ 97/4025	D.El.Ed	1	2002-6-24	2002-03/341	MSCERT

The above provided information pertaining to my institution is true to the best of my knowledge. For any deviation and false information, myself and my institution/Trust/Society/Company would be held responsible, and NCTE would be at liberty to take necessary action against my institution/Trust under relevant provisions of NCTE Act/Rule/Regulations.

Any Other Information

Name of the Authorised Person

SMT. DURGVADE DIPALI CHANDRAKANT

Designation of the Authorised Person

PRINCIPAL

Mobile Number of the Authorised Person

9970808600

**Annexure 5 : Assessment and Accreditation Council (NAAC)**
**Annexure 6 : Quality Council of India (QCI)**



**Annexure 7 : QCI in connection with E- monitoring**



## E-Monitoring Acknowledgement Slip

Registration No	TEIEM003346
Institute Name	Kamla Nehru Junior College Of Education Karad
Email	knjekarad@yahoo.in
Mobile	9158030999
Transaction ID	271113962
Merchant RefNo	1611164757297
Transaction Mode	Online
Transaction Status	0300 - success
Transaction Date	16-11-2016
Payment	3150.00

## Annexure 8: Recognition Document







**NATIONAL COUNCIL FOR TEACHER EDUCATION**  
WESTERN REGIONAL COMMITTEE, BHOPAL

**राष्ट्रीय अध्यापक शिक्षा परिषद्**

मानस भवन, श्यामला हिल्स, भोपाल-462002  
पश्चिम क्षेत्रीय समिति, भोपाल



No.WRC/5-6/97/ 1625

Date: 24 NOV 1997

**Order**

In exercise of the authority vested under Section 14(3)(a) of the National Council for Teacher Education Act, the Western Regional Committee grants provisional recognition to **Kamala Nehru Jr. College of Education, Karad** for the following courses –

S.No.	Course	Intake	Period
1.	D.Ed.	40	Provisional recognition upto 1998-99

The institution does not fulfil the requirements for recognition laid down in the regulations notified in accordance with the provisions of the NCTE Act, 1993 and therefore the Committee further lays down conditions which are to be complied as follows–

1. Furniture should be provided as per NCTE norms. \*
2. Library should be strengthened..
3. Science and Psychology Laboratories for work experience workshop be provided.

The institution is advised to send a compliance report upto 31 January, 98 as to the removal of deficiencies so that a new team may be sent to verify the same.

By order

Regional Director

Code 

1	1	2	0	4	3
---	---	---	---	---	---

cc:

The Principal, Kamala Nehru Jr. College of Education, Karad.

The Director, Maharashtra State Board of Examination, 17- Dr. B.S. Ambedkar Marg,  
Pune

TRUE - TRUE - COPY

कमला नेहरू ज्युनियर कॉलेज  
ऑफ एज्युकेशन, कराड  
ना. कराड, जि. सातारा

Annexure 9 : Building Document



## मालमत्ता पत्रक

विभाग/मोजे -- सोमवारपेट-कराड

तालुका/न.भु.मा.का. -- कराड

जिल्हा -- सातारा

स.स. क्रमांक	रिजि. नंबर	प्लॉट नंबर	क्षेत्र	धारणाधिकार	शासनाला दिलेल्या आकाराचा किंवा भाड्याचा तपशील आणि त्याच्या धर. तपसणीची निश्चिंत बंध
४५९क					

[८०]

सो.मो.

६६.९

A

मुद्रिणाधिकार

हक्काचा मूळ धारक  
यवे

श्रीमंत पंत प्रतिनिधी सो. - वडिलोपिल

पट्टेदार

इतर भार

इतर शेरे

क्रमांक	व्यवहार	खंड क्रमांक	मंथन धारक (धा) पट्टेदार (प) किंवा भार (भा)	साक्षात्कृत
२०/११/१९५२	सि स नं० ४५७ अ घास लिहिनेप्रमाणे		H श्रीमंत भाग्यतराव त्रिंबकराव पंतप्रतिनिधी आंधि अ. पा. क. कलेक्टर आणि कोर्ट ऑफ अपॉईंट्स पुणे	करार क्र. ० प्रमाणे सो. - २०/११/१९५२
०४/०९/१९६०	सि स नं० ४५६ ब १ अ पावर लिहिने प्रो नाथ दाखल (R)		H श्री स्वामी विवेकानंद शिक्षण संस्था यांची शाखा कराड येथील कमलानिहार अध्यापिका विद्यालयाय तर्फे सेक्रेटरी	करार क्र. ० प्रमाणे सो. - ०४/०९/१९६०
०४/१२/१९६८	भा. स. च्या १९५६ च्या वजनमापाचे कायदा लागत म. स. च्या १९५८ अंमल बजावणी कायदानुसार व भा. स. च्या नाणी संबंधी कायदानुसार क्षेत्र आकाराचे रुपांतर केले.			करार क्र. ० प्रमाणे सो. - ०४/१२/१९६८
०४/१०/१९६९	सि स नं० ४५७ अ पावर लिहिनेप्रो		H) श्रीमंतराजे राहब श्रीपलराव भगवंतराव पंतप्रतिनिधी आंधि	करार क्र. ० प्रमाणे सो. - ०४/१२/१९६८
२१/०९/१९९२	श्री स्वामी विवेकानंद शिक्षण संस्था कोल्हापूर तर्फे सेक्रेटरी यांच्या अर्ज व संबंधिताची जबाब व दि. २२.९.९२चे सधर मिळकतीचे संपूर्ण क्षेत्रास नाव दाखल केले व सि स नं० ४५८ ब १ अ यातील दि. ८.९.६०चे नोंदीतील सधर सि स न कमी केला		H श्री स्वामी विवेकानंद शिक्षण संस्थेचे शिक्षण महती डॉ. थापूजी साळखे कॉलेज कराड	करार क्र. ० प्रमाणे सो. - ०६/११/१९९२

नवकल अर्ज आला तारीख.....

नवकल अर्ज तयार तारीख.....

नवकल दिली तारीख.....

नवकल अर्जदार श्री.....

तपसणी करणारा -

जरी नकल -

श्री. कराड, जि. सातारा

श्री. नवकल, जि. सातारा

श्री. नवकल, जि. सातारा

श्री. नवकल, जि. सातारा

श्री. नवकल, जि. सातारा

श्री. नवकल, जि. सातारा

श्री. नवकल, जि. सातारा

श्री. नवकल, जि. सातारा

श्री. नवकल, जि. सातारा

श्री. नवकल, जि. सातारा

श्री. नवकल, जि. सातारा

श्री. नवकल, जि. सातारा

श्री. नवकल, जि. सातारा

श्री. नवकल, जि. सातारा

श्री. नवकल, जि. सातारा

श्री. नवकल, जि. सातारा

श्री. नवकल, जि. सातारा

श्री. नवकल, जि. सातारा

श्री. नवकल, जि. सातारा

श्री. नवकल, जि. सातारा

श्री. नवकल, जि. सातारा

श्री. नवकल, जि. सातारा

श्री. नवकल, जि. सातारा

श्री. नवकल, जि. सातारा

श्री. नवकल, जि. सातारा

श्री. नवकल, जि. सातारा

श्री. नवकल, जि. सातारा

## Annexure 10 : Mutation





क्रा.नं. ५  
(नियम नं. ७)  
कराड नगरपालिका, कराड.

परवानगी क्रमांक

२६/१५-६६

क्र. नं. १३८२

तारीख 20 JUL 1995

बांधकाम सुरु करणेबाबतचा दाखला

प्रति-

श्री/ श्रीमती रवानी विवेकानंद शिवाजी संस्था सोपीयाना कराड येथील कमळा  
नेहरू इन्स्टीट्यूट ऑफ टेक्नॉलॉजी वर  
सुमने दिनांक २५/०७/१९९५ कराड  
येथील जमीन मालकी क्रमांक ४५८९/१९९५ कराड  
महाराष्ट्र पारंपरिक व नगरविकास अधिनियम १९६६ चे कलम ५५ अन्वये सुम्हास पेठ सोप वर  
सि. स. नं. / का. क्र. नं. ४५८९/१९९५ या ठिकाणी बांधकाम करणेस परवानगी देणेत येत आहे इमारतीचे  
बांधकाम साशिल नमुद देलेल्या माटोस पाव राहून करणेचे

- १) अर्जदार यांनी खातर केलेल्या व इच्छित कार्यालयाने मंजूर केलेल्या / रवाना बदल केलेल्या प्लान प्रमाणे बांधकाम करणेचे आहे. अर्जदारीत कोणतेही जादा बांधकाम करणेचे नाही.
- २) महत्त्वपूर्ण बांधकाम करणेचे आहे. / बांधकाम करणेचे आहे.
- ३) बांधकामाचे उद्देश्य / इन्टेंड हेरबाब कोणत्याही प्रकारची जागा घेणार नाही, याची दखता अर्जदार यांनी घ्यावयाची आहे.
- ४) याकाठी नगरपालिका, भाजकी अथवा नागरिक अर्थसंचालनालयाने, त्याची सर्वेस्वी अबाधकारी अर्जदार यांचेवर राहिल; नगरपालिकेवर राहणार नाही.
- ५) सर्व विच्छेदनीय बांधकामातून कोणतेही कायम करत घेवून नगरीय विच्छेदनीय रकमेचे प्रमाणे मालकी हक्क व केवळी भाजकी सुधारक बांधकाम करणेचे आहे.
- ६) नगरपालिकेचे बांधकाम करणेचे इच्छित कार्यालयाने मंजूर नगरपालिकेचे बांधकाम नियमानुसार असलेले तपासून घेणेचे आहे.
- ७) विच्छेदनीय बांधकामाची बाब न्याय प्रविष्ट असेल तो वसाही प्रकारचे बांधकाम करणेचे नाही.
- ८) विच्छेदनीय बांधकामाची बाब न्याय प्रविष्ट असेल तो वसाही प्रकारचे बांधकाम करणेचे नाही.
- ९) बांधकाम पूर्ण झालेवर बांधकाम पूर्ण झालेला घेवून मग यावर सुरु करणेचे आहे.
- १०) सर्व विच्छेदनीय बांधकामातून कोणतेही कायम करत घेवून नगरीय विच्छेदनीय रकमेचे प्रमाणे मालकी हक्क व केवळी भाजकी सुधारक बांधकाम करणेचे आहे.
- ११) या बांधकाम प्रकरणी अर्जदार यांनी दिलेली माहिती, खातर, केलेली कागदपत्रे खोटी अगर विद्यामूळ करणारी असलेचे सादर उक्त परवानगी रद्द करणेचे येईल.
- १२) या बांधकामाने कोणतेही मटेरियल (दगड, वाळू, स्टील बर्दरे) रस्त्यामध्ये ठेवणेचे नाही.
- १३) सर्व बांधकामातून कोणतेही परवानगी रद्द करणेचे अर्जदार यांनी राहिल ठेवलेला आहे.
- १४) बांधकामाची उंची संसाधन बांधकामाचे फ्लोअर म्यारो मटेरियल जोडणारी खिळीत वेगळी परवानगी घेणेची असून संसाधन बांधकामाचे कोणतेही लोखंड म्यारो मटेरियलमध्ये निचरा होणेचे नुदने ठेवणेचे आहे.
- १५) कमो ब्राँज मध्यम दाबाच्या विद्युत तारापासून उभे अंतर (Vertically Distance) कमोत कमो २-५ मीटर व जावचे अंतर (Hori Zontally Distance) १-२ मीटर सोडून बांधकाम करणे आवश्यक आहे.
- १६) उभे दाबाच्या विद्युत तारापासून उभे अंतर (Vertically Distance) कमोत कमो १.७ मीटर व जावचे अंतर (Hori Zontally Distance) २-०० मीटर सोडून बांधकाम करणे आवश्यक आहे.
- १७) बांधकामासाठी अर्जदारीत साहित्य तबदीत आपल्या हद्दीत घेणेचे आहे व निकामी मटेरियल तीन दिवसात रस्त्यावरून दूरबाहेर उचलणेचे आहे अथवा या काही घेणारा वर्षे विसावले मधून वजा केला जाईल.

सर्व बांधकाम परवानगी ही परवानगी तारखेपासून एक वर्षे कायदेनीत आहे.

ठिकाण \_\_\_\_\_

तारीख २०/७/९५

विच्छेदनीय इन्स्पेक्टर  
कराड नगरपालिका, कराड

म्युनिसिपल इंजिनियर  
कराड नगरपालिका, कराड

मुख्याधिकारी  
कराड नगरपालिका, कराड

प्रत माहितीसाठी रवाना -  
सा. परिदृश्य प्रमाणन अधिकारी, कराड



Annexure 11 : Land Document





BOMBAY STATE

100 Rs



SN- 270 STAMP OFFICE, POONA Dated 12/12/60

General Postage 10+30+2-50+100 = 232-50 NF.

Two hundred & Thirty Two / 50 NF.

Issued to Shri S. D. Salunkhe, Secretary, Shri Swami Vivekanand Shikshan Sanstha.

Address Kolhapur.

Stamp Paid K.R.D. 12/12/60 POONA



सखेची सिटी नंबर १८८ व  
१३  
सोमवार चेचे असखेची नोंद

KRD
1844-368
1960

पिताच्या कोट पैकी वाचे किह्या म्हणु जोळखली—  
जाणारी पैकी रकमरकूट १०१३०/ सतराहजार  
चारबो तीस व सिटी नंबर १८८ क. संघा  
याचे क्षेत्र ०२० सालरोवीस रकमरकूट मिळून  
राकूण १८१२० चौरसफूट आठराहजार (अशे पन्नास





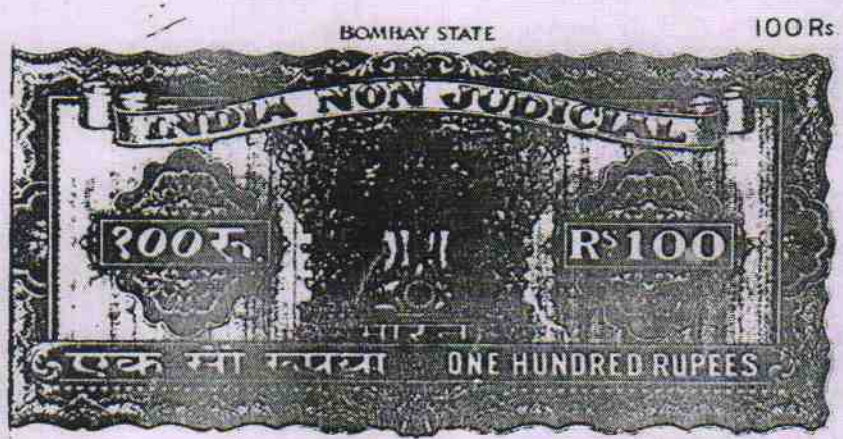

Net - 270 STAMP OFFICE, POONA Date 12-8-60  
 General Stamp of Rs. 100 + 50 + 20 + 1-00 = 171-00  
 Two hundred & Thirty Two / 50 P.  
 Issued to Shri. Soudrao Dyanoji Sankhale  
 Secretary Shri. Swami Vivekanand Shikshan, Sadhana  
 self, Karvepura.  
 Address... Kolhapur

*R. K. Kauthe*  
 Stamp Head Office 12/8/60  
 Poona

*Handwritten notes in Marathi:*  
 कर्तव्य...  
 या 100 रु...  
 20 रु...  
 50 रु...  
 1 रु...  
 171 रु...

**KRD**  
 1844-1/8  
 1960

कीलडी वीट 30.00  
 ए. वी. वी. 5.00  
 ए. वी. वी. 5.00  
 ए. वी. वी. 5.00  
 ए. वी. वी. 5.00

*Handwritten signature and notes:*  
 श्रीगजानन  
 रवरेदीखत जिगा उत्तर सातारा ज्ये कराड पैकी  
 गांव "कराड" येथील मिळकतीचे किंमत रुपये

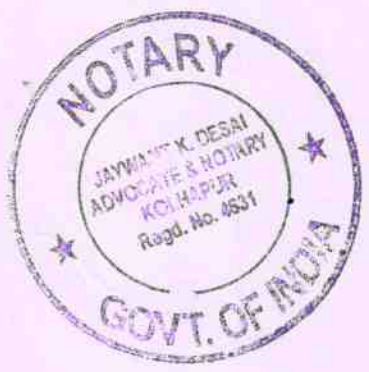

स्वात हजार, नऊशे शाहानरचे  
 डाके १८८२ मिति श्रावण या  
 रोज बुधवार तारिख १२ माहे आषाढ सन  
 १८६०  
 शिल्ले दिवशी:-

KRD
1844-218
1960

१ श्री स्वामी विवेकानंद शिक्षण संस्था  
 कोल्हापूर यांची शाखा कराठ येथील कमळा  
 नेहरु आध्यापिका विद्यामंदीरचे तर्फे सेक्रेटरी  
 श्री. नोबिंदराय जानोगी साबुंरने हिंदू  
 वय २२ सुमारे घंटा सोशल व्कीर राठ  
 कोल्हापूर.

रबरेदी  
 स्वत  
 विग  
 येणार.

यांसी.

१ श्रीमंत भगवंतराव भिंबकराव पंत  
 प्राचीनिधी 'राजेस्पो' उद्योग तर्फे कलेक्टर  
 व कोर्ट ऑफ वॉर्स पुणे.

रबरेदी  
 येणार.

कारणे रबरेदीरवत लिहून देणेत येणेकी:-

१ मिल्कलीचे वर्णन:- लुकरी उत्तर सातारा त्पो  
 कराठ पैकी कराठ मे सव् रजिस्ट्रार सात यांचे  
 हद्दीतील गांव " कराठ " येथील म्युनिसिपल व्हायस





ERD  
1844-45  
1960

श्री ० महाशिव नाथ कृष्ण कुलकर्णी  
कन्वेणरसो न श्रीमंत भगवंत राम  
जिं वसुदेव पुंन सति निधी राजे मो  
जोप याचे इस्वीने कोर्ट ऑफ वॉर्ड पुणे  
यांना सम प्रोपे हे इन्सालचे नोंदणी  
कामधारे सधम ह ० अन्वये जातीने हजर  
गहणेची माफी आहे त्यांनी सही स्वहती  
सही करणार सब गजिदर फोचरवताल  
तारीख २२ साडे ऑगस्ट १९६०



श्री. दी. म. विं. डे  
सब गजिदर, फारु.

१ नोंदणी नुसत  
१९६० नोंदणी नुसत  
श्री. दी. म. विं. डे  
सब गजिदर  
तारीख २२ साडे ऑगस्ट  
ज १९६०

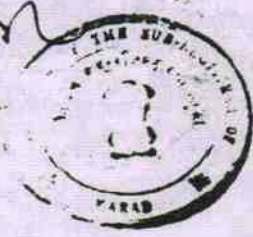

Annexure 12 : Builling Plan

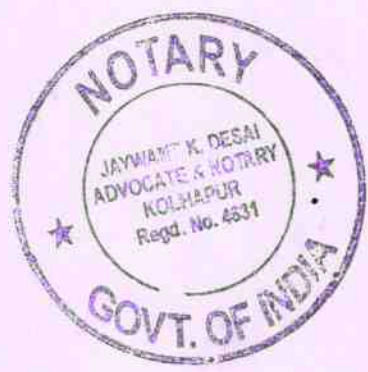

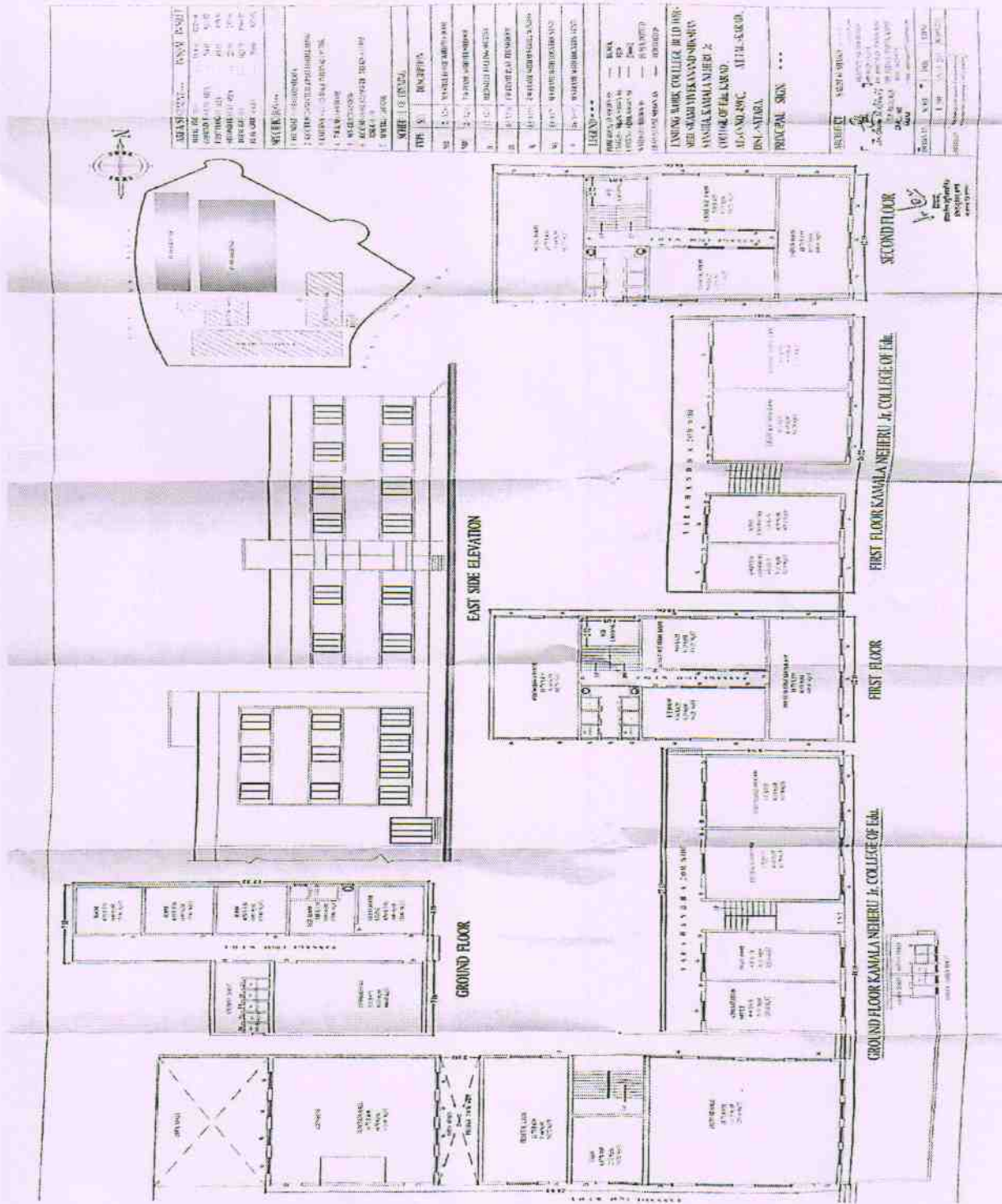

Annexure 13 : Building Completion Certificate





☎ (०२१६४) २२२२३७ (कार्यालय)  
२२२३६३ (निवास)  
फॅक्स - २२३४१६



मुख्याधिकारी  
कराड नगरपरिषद कराड.  
जि. सातारा ४१५ ११०

जा. नं. नया / कावि / करत खुली निघाज / 60201300000151 दिनांक - 9/ JAN 2013

### दाखला

दाखला देणेत येतो की, पेठ सोमवार सि. स. नं. ४५९ क आणि ४५८ ब/१/१अ/१ ही मिळकत इकडील असेसमेंट रजिस्टर पाहता कमला नेहरु ज्युनिअर कॉलेज ऑफ एज्युकेशन व कमला नेहरु वस्तीगृह या शैक्षणिक कामासाठी व विद्यार्थ्यांच्या निवासासाठी वापरांत असलेचे दिसून येते. हा दाखला आपले संस्थेचे इकडील आ. नं. २१९ दि. ७-१-२०१३ च्या अर्जावरून देणेत येत आहे.

सदरील दाखल्याचा 'हमीपत्र' म्हणून उपयोग करता येणार नाही.



मुख्याधिकारी,  
कराड नगरपरिषद, कराड.

प्रत :- मा. प्राचार्य,  
कमला नेहरु ज्युनि. कॉलेज ऑफ  
एज्युकेशन, कराड.

### Annexure 14: Faculty Certificate



SHIVAJI UNIVERSITY, KOLHAPUR



1. '-' indicates passed in previous attempt.

No. 156

STATEMENT SHOWING THE NUMBER OF MARKS OBTAINED BY

Shri/Smt. Chavan Asyama Deeliprao

in each head of passing at the M. Ed. Examination held in March/April, 1997

- 1) First Class with Distinction : 70% Marks separately in Theory ( including Viva-voce ) and in the Practicals and 75% in aggregate. (385-175-600)
- 2) First Class : 60% Marks separately in Theory ( including Viva-voce ) and in the Practicals and 65% in aggregate. (330-150-530)
- 3) Second Class with B+ : 55% Marks separately in Theory ( including Viva-voce ) and in the Practicals (303-138-440)
- 4) Second Class : 50% Marks separately in Theory ( including Viva-voce ) and in the Practicals (275-125-430)

Seat No.	Theory Papers				Optional Papers		Practical Work						CLASS			
	Compulsory Papers		III		Group		Theory Total		Practical Work					Practical Total	Grand Total	
	I	II	III			Paper-IV	Paper-V	Viva-Voce		Review of one recent book on Philosophy and/or Sociology of Education (Internal) Paper-I	Practical Work on any one of the topics prescribed for the (Internal) Paper-II	A Research report (Internal) on a topic related to the Optional group selected Paper-III	Educational excursion/case Study Internship Paper-IV & Field Work (Internal) Paper-V			
156	100	100	100			100	100	50	550	50	50	50	100	250	800	
	40	40	40			40	40	20	275	20	20	20	40	125	408	
	52	48	52			49	49	40	303	46	44	38	82	210	513	Second class B+
Maximum Marks																
Minimum for Passing																
Marks Obtained																

Entered by [Signature]  
 Read by [Signature]  
 Checked by [Signature]  
 Kolhapur

02 JUN 1997

[Signature]  
 Dy. REGISTRAR

PRINCIPAL  
 Kamala Nehru College of Education  
 Karad, Tal. Karad, Dist. Solapur







यशवंतराव चव्हाण महाराष्ट्र मुक्त विद्यापीठ, नाशिक - 422 222

शिक्षणशास्त्र निष्णात शिक्षणक्रम (MASTER OF EDUCATION) (M.Ed.)

गुणपत्रक (Marksheet) परीक्षा May, 2005

विद्यार्थ्याचे नाव : विठ्ठल अशिका शिंदेकर

अभ्यास केंद्र : 7518

कार्यम नोंदणी क्रमांक : NM0400243

परीक्षा केंद्र :

परीक्षा आसन क्रमांक : TM00343

अभ्यासक्रम संकेतक व नाव	संभाव्य गुण	प्राप्ति गुण	कमाल गुण	प्राप्त गुण
EDU 005 शिक्षणाचे तात्विक, सामाजिक व सांस्कृतिक पार्श्वदर्शन Philosophical & Socio-Cultural Perspective of Education	25	25	100	79 *
EDU 006 शिक्षणाचे मानसशास्त्रीय पार्श्वदर्शन Psychological Perspective of Education	25	68	100	67 *
EDU 008 मूल्यनिर्धारण व मूल्यमापन Assessment & Evaluation	25	52	100	59 *
EDU017 Research Methods and use of statistics	21	68	100	63 *
EDU012 Educational Management and Administration	33	65	100	73 *
EDU013 Educational Planning	33	65	100	70 *
संशोधन प्रकल्प व मौखिक परीक्षा Research Project & Viva	200	162	200	162
	एकूण	800	800	570

प्रतिशत गुण : 73.75

निकाल : First Class

Note : Incomplete Component.

TRUE-COPY

नाशिक, दिनांक : 11/10/2005

Kamala Nehru College of Education  
Karad Tal. Kolhapur Dist. Satara



\* 0 4 0 0 1 0 9 5 \*









SHIVAJI UNIVERSITY, KOLHAPUR

No. 780



I. 'P' indicates passed in previous attempt.

STATEMENT SHOWING THE NUMBER OF MARKS OBTAINED BY

*Sr/smt. Upadhye Vishakha Purandhar Padmarati.*

in each head of passing at the M. Ed. Examination held in ~~March/April-109~~ Nov/Dec. 2011.

- 1) First Class with Distinction : 70% Marks separately in Theory (including Viva-voce) and in the Practicals and 75% in aggregate. (385-175-600)
- 2) First Class : 60% Marks separately in Theory (including Viva-voce) and in the Practicals and 65% in aggregate. (330-150-520)
- 3) Second Class with B+ : 55% Marks separately in Theory (including Viva-voce) and in the Practicals (303-138-440)
- 4) Second Class : 50% Marks separately in Theory (including Viva-voce) and in the Practicals (275-125-400)

4

Sect No.	Theory Papers			Optional Papers Group		Practical Work						Grand Total	
	I	II	III	Paper-IV	Paper-V	Viva-Voce	Theory Total	Review of one recent book on Philosophy and/or Sociology of Education (Internal) Paper-I	Practical Work on any one of the topics prescribed for the (Internal) Paper-II	A Research report (Internal) on a topic related to the Optional group selected Paper-III	Educational excursion/case Study Internship Paper-IV & Field Work (Internal) Paper-V		Practical Total
	100	100	100	100	100	50	550	50	50	50	100	250	800
	40	40	40	40	40	20	275	20	20	20	40	125	400
	P51	77	78	P57	P58	P35	356	P35	P35	P40	P80	190	546
													First Class

CLASS

Entered by *[Signature]*  
 Read by *[Signature]*  
 Checked by *[Signature]*  
 Kolhapur 23 JAN 2012

Under Improvement of Class

*[Signature]*  
 Controller of Examinations







# Dr. BABASAHEB AMBEDKAR MARATHWADA UNIVERSITY,

AURANGABAD - 431 004. (Maharashtra State - INDIA)

## STATEMENT OF MARKS

Sr No. **H 0584942**

MASTER OF EDUCATION (M.Ed) EXAMINATION HELD IN MAR/APR - 2008

SEAT NO. : 9027

Computer Code -1403950

NAME : GHUGE EKNATH JANARDHAN

COLLEGE: DR. BABASAHEB AMBEDKAR MARATHWADA UNIVERSITY (Dept.) - A'BAD.

SUBJECT	MAXIMUM MARKS	MINIMUM MARKS	OBTAINED MARKS
Philosophical & Sociological Foundations of Education	100	40	67
Psychological Foundations of Education	100	40	66
Methodology of Educational Research	100	40	63
Educational Technology	100	40	58
Teacher Education	100	40	82
Viva-Voce of the Dissertation	100	50	81
Practicum and Internal Assessment	200	100	155
** ZERO FIVE SEVEN TWO **	TOTAL :	800	350
			572

RESULT: Passed in First Divn. With Distinction

DATE: June 14, 2008

CONTROLLER OF EXAMINATIONS

Exempted, PR - Practical / Oral, Ab - Absent, Th - Theory, CT - Case Test, Tt - Tutorial, TUE - Theory University Exam, TIV - Theory Internal Exam, TIO - Theory Total, N - Practical Internal Exam, PUE - Practical University Exam, PTU - Practical Total, PW - Project work, DA - Dept. Assessment, CE - Department, IA - Internal Assessment, PP - Paper.

Attested By  
Lecturer  
Dnyaneshwar Ghuge  
Sonapani, Aurangabad

जानक्योती अध्यापक महाविद्यालय  
सोमनाथ, जि. सातारा

प्राचार्या,  
कमला नेहरु ज्युनियर कॉलेज  
ऑफ एज्युकेशन, कराड  
ता. कराड, जि. सातारा





**DE. BABASAHEB AMBEDKAR MARATHWADA UNIVERSITY,**

AURANGABAD - 431 004. (Maharashtra State - INDIA)

**STATEMENT OF MARKS**

Sr. No. H 403304E

MASTER OF EDUCATION (M.Ed) EXAMINATION HELD IN MAR/APR - 2010

SEAT NO. : 8111

Computer Code -1600774

NAME : KASBE ANAND BABURAO

COLLEGE : DR. BABASAHEB AMBEDKAR MARATHWADA UNIVERSITY (Dept.) - A' BAD.

SUBJECT	MAXIMUM MARKS	MINIMUM MARKS	OBTAINED MARKS
Philosophical & Sociological Foundations of Education	100	40	57
Psychological Foundations of Education	100	40	66
Methodology of Educational Research	100	40	73
Special Education	100	40	60
Teacher Education	100	40	70
Viva-Voce of the Dissertation	100	50	79
Practicum and Internal Assessment	200	100	155
** ZERO FIVE SIX ZERO **	TOTAL :	600	350
			560

RESULT : Passed in First Divn. With Distinction

DATE : July 23, 2010

CONTROLLER OF EXAMINATIONS

Ex - Exempted, PR - Practical / Oral, Ab / AA - Absent, Th - Theory, CT - Class Test, Tw - Termwork, TU - Theory University Exam, TI - Theory Internal Exam, TT - Theory Total,  
 T - Total of Termwork and practical, PI - Practical Internal Exam, PU - Practical University Exam, PT - Practical Total, PW - Projectwork, DA - Dept. Assessment, SE - Sessional IA - Internal Assessment, PP - Paper

T/C

  
**Lajesh L. Waghmare**

M.A.L.L.B.

 ADVOCATE  
 Dist. Court Beed.



**UNIVERSITY OF PUNE**  
GANESHKHIND, PUNE 411 007.

STATEMENT OF MARKS FOR  
EXAMINATION MASTER OF EDUCATION (GENERAL) (REVISED - 2002)

SEAT NO. 18 P.R. NO.: 2220070112  
 NAME KHATAKI RAJARAM BANDOPANT Mother: SANSABAI  
 CENTRE NO. PUNE (1) INSTITUTE / COLLEGE 074 ADHYAPAK MAHAVIDYA, PUNE  
 YEAR APRIL 2007 COURSE NAME MARKS OBTAINED OUT OF PASSING MARKS

OPTIONAL PAPER GROUP B : 111 113

PART : I (OUT OF : 100 PASSING : 50)			
GROUP : A			* 71
101 EDUCATION IN CONTEMPORARY SOCIETY			* 57
102 ADVANCED EDUCATIONAL PSYCHOLOGY			* 55
103 EDUCATIONAL RESEARCH AND STATISTICS			
GROUP : B			* 80
111 EDUCATIONAL MANAGEMENT			* 62
113 TEACHER EDUCATION			
TOTAL	500	250	325
PART : II (OUT OF : 100 PASSING : 50)			* 85
201 PRACTICAL RELATED WITH THEORY PAPERS			* 76
202 TUTORIALS			* 74
203 INTERNAL TESTS			* 76
204 SEMINAR READING ON R.P., CURRICULUM & I.P.			
TOTAL	400	200	311
PART : III (OUT OF : 50 PASSING : 25)			* 38
301 REPORT WRITING OF RESEARCH			* 38
302 VIVA VOCE OF THE RESEARCH			
TOTAL	100	50	76
(PART: I 325/500 II 311/400 III 76/100) GRAND TOTAL	1000	500	712

FIRST CLASS WITH DISTINCTION

\*\*\* CONGRATULATIONS \*\*\*

*Beary*

DATE 13 JULY 2007

